

### OPTION # 1 CURB AND SIDEWALK REPLACEMENT

NOT TO SCALE

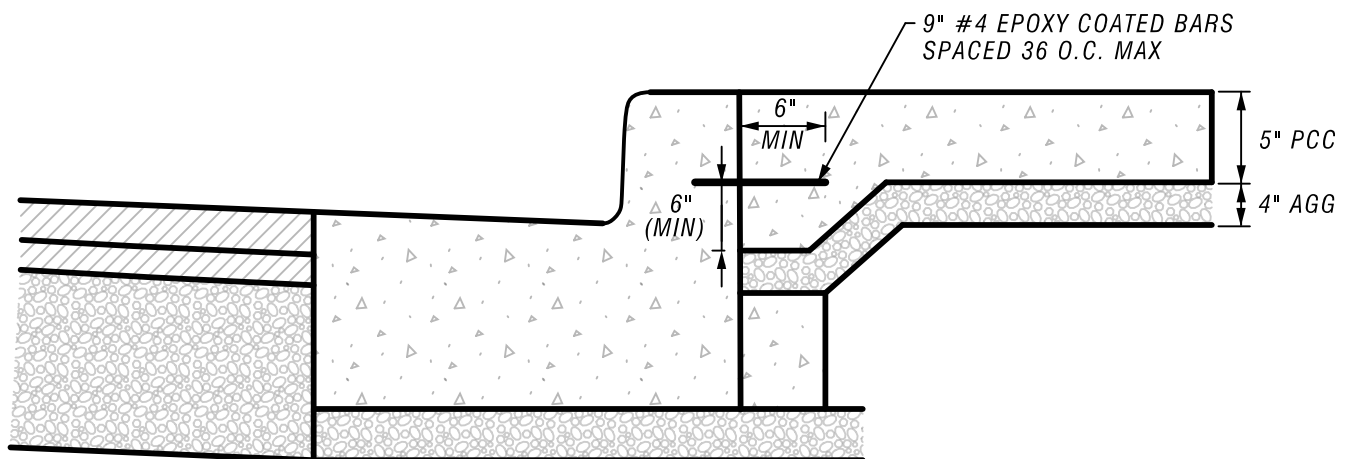

### OPTION # 2 SIDEWALK REPLACEMENT ONLY

NOT TO SCALE

### NOTE

1. SEE DETAILS FOR SIDEWALK CURB AND GUTTER FOR ADDITIONAL INFORMATION.
2. ALL REINFORCEMENT SHALL BE SUPPORTED AND TIED TOGETHER PRIOR TO CONCRETE PLACEMENT. ALL RELATED COSTS SHALL BE INCIDENTAL.
3. OPTION NO. 2 THICKENED EDGE TO BE USED WHEN EXISTING CURB IS TO REMAIN. ALL RELATED COSTS SHALL BE INCIDENTAL.
4. FULL DEPTH SAWCUT TO BE USED BETWEEN CURB AND CARRIAGE WALK WHEN ONLY ONE IS BEING REMOVED/REPLACED

REVISED 12-16-24



**PUBLIC SIDEWALK  
TIE TO CURB**

